

Floor Plan

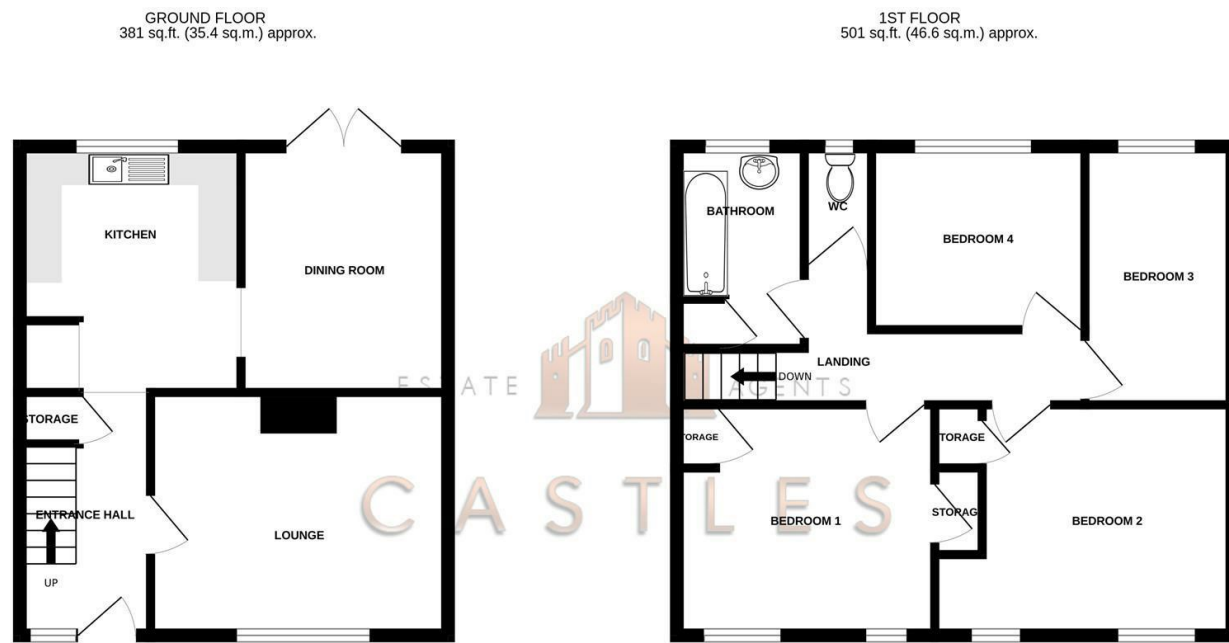

TOTAL FLOOR AREA: 882 sq.ft. (82.0 sq.m.) approx.

Whilst every attempt has been made to ensure the accuracy of the floorplan contained here, measurements of doors, windows, rooms and any other items are approximate and no responsibility is taken for any error, omission or mis-statement. This plan is for illustrative purposes only and should be used as such by any prospective purchaser. The services, systems and appliances shown have not been tested and no guarantee as to their operability or efficiency can be given.
Made with Metroplan ©2020



322 Allaway Avenue
Portsmouth, PO6 4QS

We are pleased to welcome to the market this four bedroom mid terrace property located in Allaway Avenue, Paulsgrove.

The property is well presented throughout and the ground floor consists of a lounge room to the front of the home with a modern kitchen and dining room to the rear.

Moving upstairs there are four bedrooms, a bathroom and a separate w/c.

Externally there is a front garden which has the potential to be converted to a driveway for off road parking like most of the neighbours have done, subject to local council permissions of course. The rear garden is a generous size and features brick built storage along with side access.

For more information or to arrange a viewing please call Castles today.

Offers over £270,000

These particulars, whilst believed to be accurate are set out as a general outline only for guidance and do not constitute any part of an offer or contract. Intending purchasers should not rely on them as statements of representation of fact, but must satisfy themselves by inspection or otherwise as to their accuracy. No person in this firm's employment has the authority to make or give any representation or warranty in respect of the property.

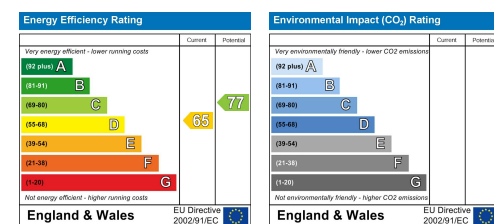

322 Allaway Avenue

Portsmouth, PO6 4QS

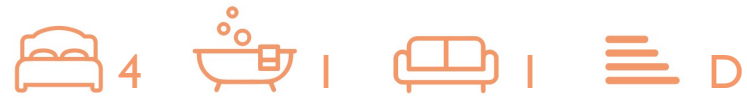

- FOUR BEDROOMS
- MODERN KITCHEN
- GENEROUS REAR GARDEN
- TWO RECEPTION ROOMS
- SIDE ACCESS
- CLOSE TO LOCAL SHOPS

LOUNGE

12'5" x 13'1" (3.8 x 4.0)

DINING ROOM

8'10" x 10'5" (2.7 x 3.2)

KITCHEN

9'6" x 10'2" (2.9 x 3.1)

BATHROOM

5'2" x 7'2" (1.6 x 2.2)

W/C

2'3" x 4'11" (0.7 x 1.5)

BEDROOM 1

11'1" x 13'1" (3.4 x 4.0)

BEDROOM 2

10'5" x 12'5" x 13'1" (3.2 x 3.8 x 4.0)

BEDROOM 3

6'2" x 10'5" (1.9 x 3.2)

BEDROOM 4

9'2" x 7'10" (2.8 x 2.4)

Financial Services

If you are looking to get a comparison on your mortgage deal then do let us know as we can put you in touch with some independent mortgage advisors that would be happy to help. It is always worth a last minute comparison before you purchase a property as the current deals can change weekly.

Solicitors

If you are looking for a solicitor to handle the conveyancing process then do let us know as we can point you in the direction of some local, well recommended companies that would be happy to help and provide you with a quote.

Anti Money Laundering

Castles Estate Agents have a legal obligation to complete anti-money laundering checks at our cost via a portal called Credas. Please note the Credas AML check includes taking a copy of identification for each purchaser, a proof of address and proof of name document is required. Please note we cannot agree a transaction without the Credas AML check being completed and there will be a small admin fee of £25+VAT charged to the successful purchasers to complete these legally required checks.

